



HIGH-EFFICIENT HARD-MOUNT INDUSTRIAL WASHER-EXTRACTOR

BC30

13,6KG

Maximized throughput, minimized costs. That's what busy on-premises laundries demand. IPSO hard-mount washer-extractors deliver those results, while producing exceptional finished wash quality. In addition, their durability ensures the machines will be consistent laundry performers for years to come.

STRENGTH

Our computer-optimized, heavy-duty frame is lighter, lasts longer, balances loads more efficiently, and reduces sound and vibration levels. IPSO washer-extractors also boast two triple-lip seals and an excluder-face seal for seven layers of bearing protection.

POWER

Proprietary inverter-drive technology provides smooth, reliable power, saving you 33% on electricity while maximizing cleaning power. Our inverter also exerts 200 G-Force extraction to remove more moisture from loads and reduce drying time.

PERFORMANCE

Available in a variety of capacities. IPSO cabinet hard-mount washer-extractors also offer a variety of control options to match your operation's unique requirements.



MODEL		BC30
CONTROL OPTION		Aries Micro OPL Aries Micro VEND
CAPACITY - kg		13.6
OVERALL WIDTH - mm		737
*OVERALL DEPTH - mm		878
OVERALL HEIGHT - mm		1142
CYLINDER DIAMETER - mm		610
CYLINDER DEPTH - mm		406
CYLINDER VOLUME - liters		118
DOOR OPENING SIZE - mm		364
DOOR BOTTOM TO FLOOR - mm		356
WATER INLET CONNECTION - mm		19
DRAIN DIAMETER - in (mm)		52
DRAIN HEIGHT TO FLOOR - mm		114
MOTOR POWER CONSUMPTION - hp (kw)		1 (.75)
TOTAL # OF SPEEDS		6, 9
CYLINDER SPEEDS - RPM (G-FORCE)	Gentle	34 (0.4)
	Wash	48 (.8)
	Distribution	86 (2.5)
	Very Low	282 (27)
	Low	485 (80)
	Medium	542 (100)
	** High	606 (120)
	**Very High	664 (150)
*** VOLTAGE/ CIRCUIT BREAKER - FLA	B	120/60/1 20-16
	X	200-208/220-240/50/60/1/3 15-6 (1 Ph) 15-4 (3 Ph)
	Q	200-208/220-240/50/60/3 15-4
	N	440-480/50/60/3 15-3
	P	380-415/50/60/3 15-3
SHIPPING DIMENSIONS APPROX. - mm	Width	800
	Depth	973
	Height	1303
NET WEIGHT - kg		209
SHIPPING WEIGHT - kg		225
SLAT CRATE SHIPPING WEIGHT - kg		268
****AGENCY APPROVALS		cETL-US, CE

*Overall depth includes vacuum breaker to door handle.

**High, Very High, and Ultra High Spin Speeds are available on the Aries Micro OPL models only.

***Circuit breaker and amp draw data shown are for models without electric heat. Consult factory for other configurations. Manufacturer strongly recommends using a circuit breaker instead of fuses. Use 3-pole circuit breakers for 3-phase machines.

****Agency approvals may vary depending on configuration. Consult factory for details. Steam connection requires 1/2" N.P.T.

For the most accurate information, the installation guide should be used for all design and construction purposes. Due to continuous product improvements, design and specifications subject to change without notice. The quality management system of Alliance Laundry Systems has been registered to ISO 9001.

Aries Micro OPL

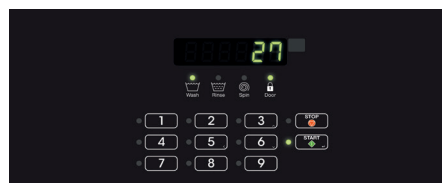

Customize your washing power with the ability to choose between three water levels while eliminating wasted water with advanced leak detection. PC programming, audit data retrieval and advanced diagnostics save time, while 200 G-Force extraction speeds reduce drying time and utility consumption.

Aries Micro VEND



For laundry managers requiring basic management options, Aries Micro VEND offers a 100 or 200 G-Force extraction speed, 4 cycle selections, 30 water levels, 2 cycle modifiers (Extra wash, Extra rinse) and manual programming.

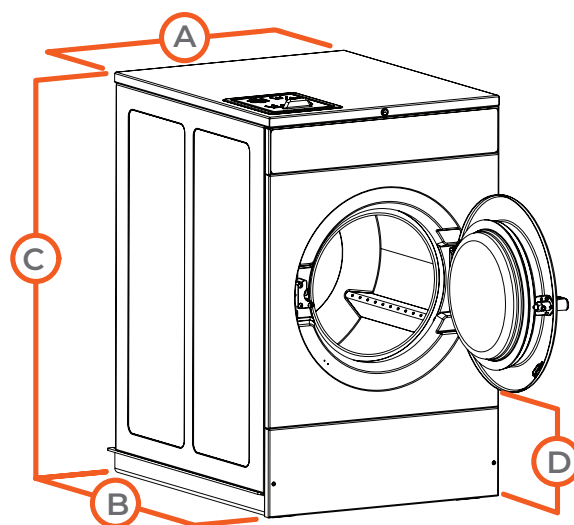

MODEL	BC30
A. OVERALL WIDTH - in (mm)	737
B. *OVERALL DEPTH - in (mm)	878
C. OVERALL HEIGHT - in (mm)	1142
D. DOOR BOTTOM TO FLOOR - in (mm)	356